

PARK AT WOODINVILLE

Industrial Space For Lease

19860-19874 141ST PL NE | WOODINVILLE, WA

CLASS A

INDUSTRIAL PARK

5

BUILDINGS

239K+

SQUARE FEET

 **Kidder
Mathews**

THE PARK AT WOODINVILLE

19860-19874 141ST PL NE, WOODINVILLE, WA 98072



FEATURES

The 239,607 SF, 5-building park is widely regarded as one of the Eastside's best-in-class assets.

NEARBY shopping, dining, and wineries

OUTSTANDING access to SR-522 and 2 miles from I-405 (one of the region's primary transportation corridors)

The Park at Woodinville is truly unmatched.

RENTAL RATES

Please contact brokers for rental and NNN rates

TODD GAUTHIER

425.450.1118

todd.gauthier@kidder.com

JASON BLOOM

425.450.1102

jason.bloom@kidder.com

PARKATWOODINVILLE.COM

This information supplied herein is from sources we deem reliable. It is provided without any representation, warranty, or guarantee, expressed or implied as to its accuracy. Prospective Buyer or Tenant should conduct an independent investigation and verification of all matters deemed to be material, including, but not limited to, statements of income and expenses. Consult your attorney, accountant, or other professional advisor.



THE PARK AT WOODINVILLE

19860-19874 141ST PL NE, WOODINVILLE, WA 98072

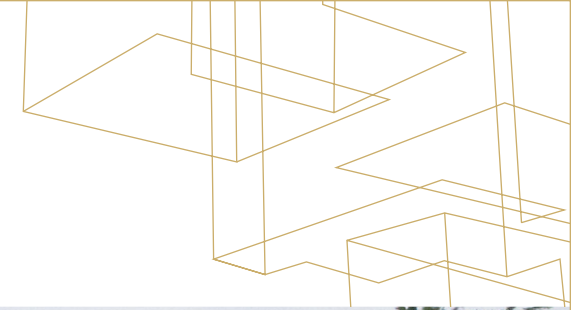

THE PARK AT WOODINVILLE

19860-19874 141ST PL NE, WOODINVILLE, WA 98072

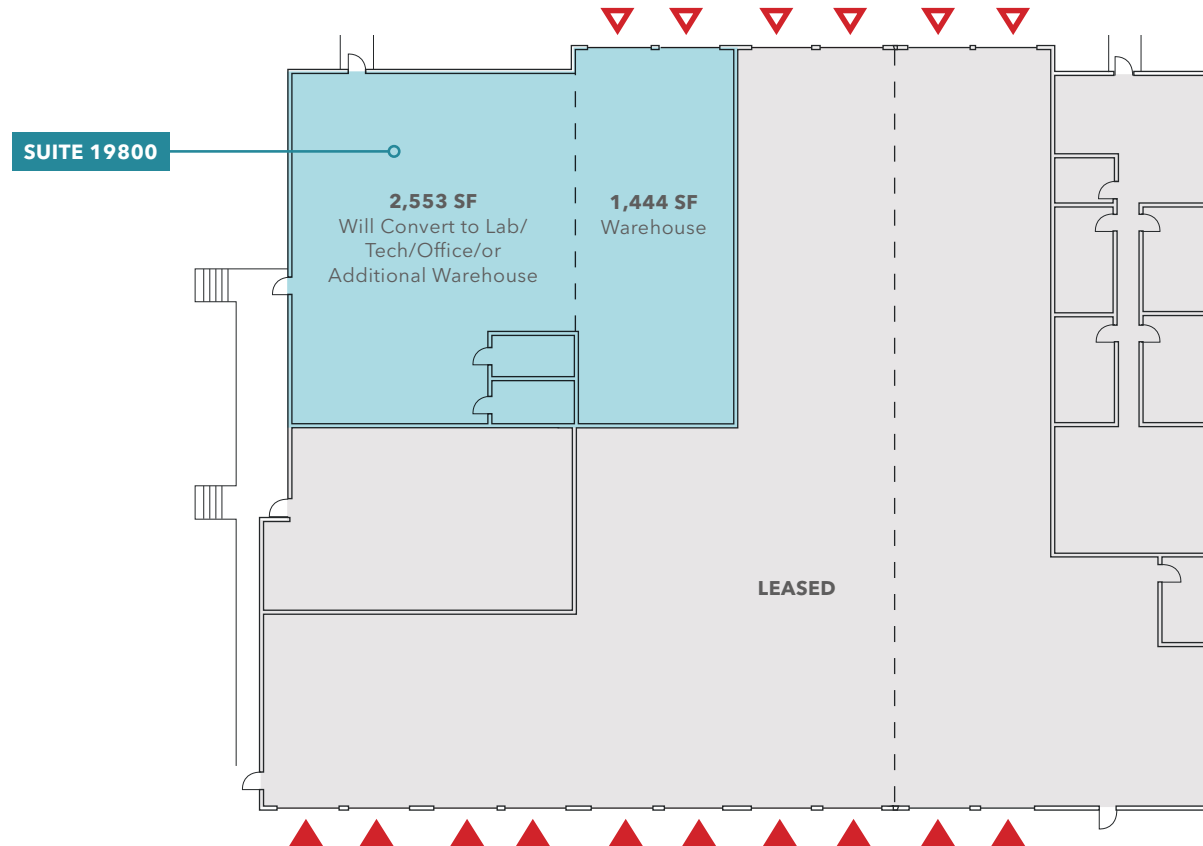

AVAILABLE SPACE

Suite	Total SF	Office SF	Whse SF	Other SF	Loading	Notes
19800	3,997	2,553	1,444		2 Dock High	* Landlord can convert space to Tenant's needs

PARKATWOODINVILLE.COM

This information supplied herein is from sources we deem reliable. It is provided without any representation, warranty, or guarantee, expressed or implied as to its accuracy. Prospective Buyer or Tenant should conduct an independent investigation and verification of all matters deemed to be material, including, but not limited to, statements of income and expenses. Consult your attorney, accountant, or other professional advisor.



BUILDING D

SUITE 1980



For leasing information contact

TODD GAUTHIER

425.450.1118

todd.gauthier@kidder.com

JASON BLOOM

425.450.1102

jason.bloom@kidder.com

PARKATWOODINVILLE.COM

This information supplied herein is from sources we deem reliable. It is provided without any representation, warranty, or guarantee, expressed or implied as to its accuracy. Prospective Buyer or Tenant should conduct an independent investigation and verification of all matters deemed to be material, including, but not limited to, statements of income and expenses. Consult your attorney, accountant, or other professional advisor.